

## General Information

Welcome to the Maryborough District Health Service Maryborough campus. Please read below information for your convenience.

### Parking

A 20 minute parking area outside the front entrance in Clarendon Street is available for clients/visitors. Alternatively, longer term street parking is available if required.

### Visiting Hours

The daily visiting hours for the Amherst ward are:

11.00 am to 2.00 pm

4.00 pm to 8.00 pm

### Services

The Maryborough campus of Maryborough District Health Service provides both Acute and Aged Care services enabling a comprehensive health service delivery to the community.

These services include:

- Preadmission Clinic
- Post acute care
- Acute Medical/Surgical/Maternity (Amherst ward)
- Theatre/CSSD/Day Surgery
- Aged care
- Day Centre (Tuaggra House)
- Primary care



Maryborough District  
**Health Service**

### incorporating:

---

**MARYBOROUGH CAMPUS**  
75-87 Clarendon Street  
Maryborough Vic 3465

Telephone: (03) 5461 0333  
Facsimile: (03) 5461 4489

---

**COMMUNITY SERVICES**  
Clarendon Street  
Maryborough Vic 3465

Telephone: (03) 5461 0400  
Facsimile: (03) 5461 4828

---

**RITCH**  
Clarendon Street  
Maryborough Vic 3465

Telephone: (03) 5461 0400  
Facsimile: (03) 5461 4828

---

**AVOCA CAMPUS**  
10 Templeton Street  
Avoca Vic 3467

Telephone: (03) 5465 1200  
Facsimile: (03) 5465 3533

---

**DUNOLLY CAMPUS**  
20 Havelock Street  
Dunolly Vic 3472

Telephone: (03) 5468 2900  
Facsimile: (03) 5468 1188



Maryborough District  
**Health Service**

*'To be a dynamic provider of quality,  
customer focused, health and  
community services'*

## **A Guide to the**

# **MARYBOROUGH CAMPUS**

75-87 Clarendon Street

PO Box 155

**MARYBOROUGH VIC 3475**

Telephone: (03) 5461 0333

Facsimile: (03) 5461 4489

[www.mdhs.vic.gov.au](http://www.mdhs.vic.gov.au)

CLARENDON STREET

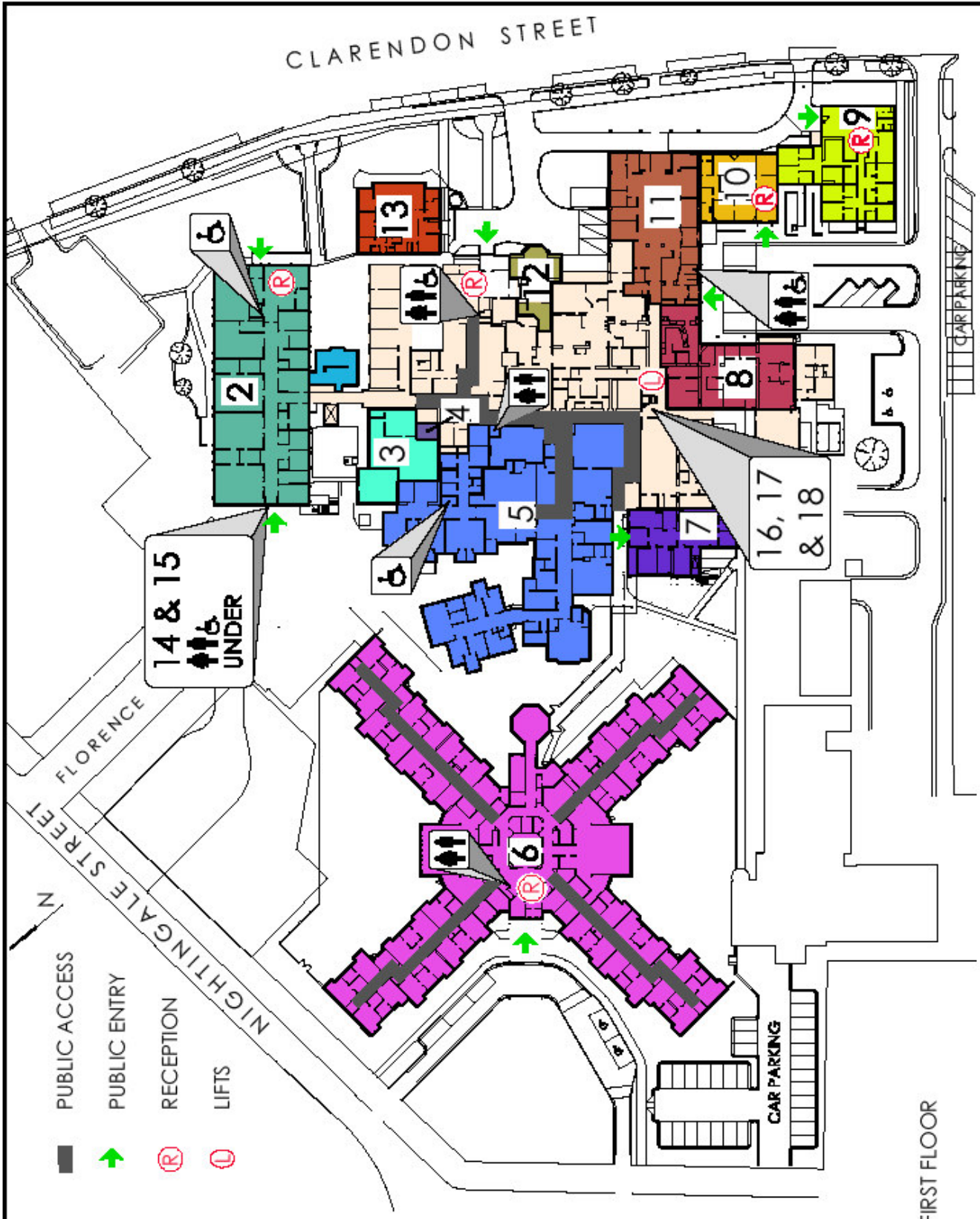

LEGEND

- 1 BLUE ROOM
- 2 COMMUNITY SERVICES
- 3 MEDICAL RECORDS
- 4 PRE-ADMISSIONS
- 5 AMHERST WARD
- 6 NURSING HOME
- 7 PHYSIOTHERAPY
- 8 MEDICAL IMAGING / XRAY
- 9 CONSULTING ROOMS
- 10 DENTAL
- 11 UCC
- 12 DAY PROCEDURES
- 13 PATHOLOGY
- 14 DISTRICT NURSING
- 15 DAY CENTRE (TUAGGRA HOUSE)
- 16 ANTE NATAL - FIRST FLOOR
- 17 STAFF DEVELOPMENT UNIT - FIRST FLOOR
- 18 BOARDROOM - FIRST FLOOR

- PUBLIC ACCESS
- ➔ PUBLIC ENTRY
- Ⓡ RECEPTION
- Ⓛ LIFTS

14 & 15  
 ♿  
 ♿ UNDER

16, 17  
 & 18

MARYBOROUGH HOSPITAL  
 DEPARTMENTAL LOCATION PLAN

